

# 70mm Speedline Acoustic Stud

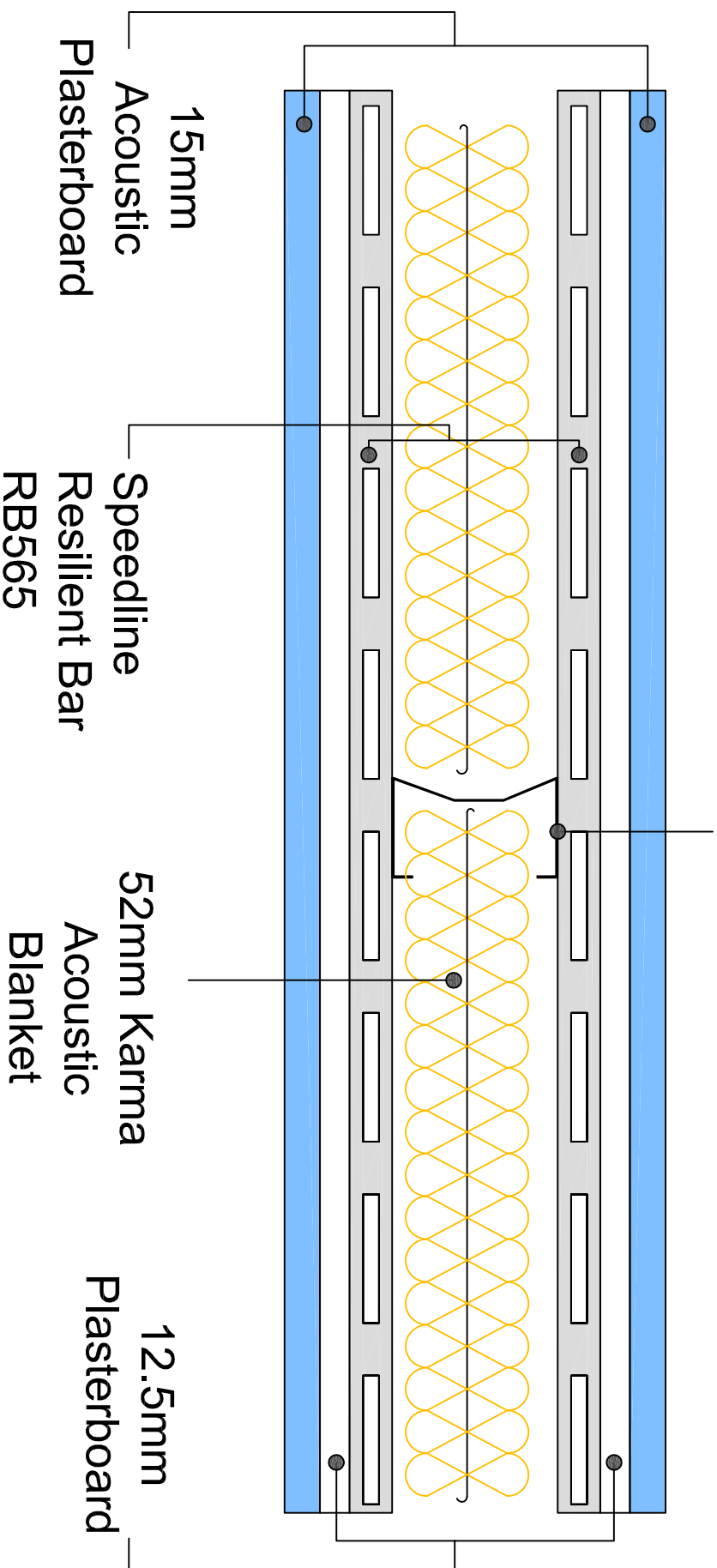

SIG Insulations Ltd  
Technical Services  
Hillsborough Works  
Langsett Road  
Sheffield  
S6 2LW

All performance data and solution specifications are for solutions constructed with the materials and components shown. The inclusion or substitution of other products invalidates both the test data and the solutions performance.

The information is provided in good faith and is based upon details received, which are assumed to include all relevant facts. While it is believed to be correct, we accept no liability for its accuracy, adequacy or completeness. Recipients must satisfy themselves as to its suitability as we do not accept any responsibility for any claims or consequential loss. Acceptance of the content and subsequent design responsibility rests entirely with the recipients who should then produce accepted details on their own company documentation. None of the content may be copied directly without prior approval from Sheffield Insulations Ltd Technical Services.

Drawn by: AF

All dimensions shown in millimetres (mm)

Karma Single Frame Solution



Date: 05/12/2007

Scale: NTS

KARMA REF: KW-004-01

© SIG Insulations Ltd